



A Photographic Guide to the Evaluation of Hazard Trees in Urban Areas  
**TREE HAZARD EVALUATION FORM** 2nd Edition

Site/Address: 988 SUMMIT AVE GEARHART  
 Map/Location: \_\_\_\_\_  
 Owner: public \_\_\_\_\_ private  unknown \_\_\_\_\_ other \_\_\_\_\_  
 Date: 9-25-23 Arborist: BAUDEN ISA#: PN0736  
 Arborist's Signature: [Signature]

HAZARD RATING:						
<u>2</u>	+	<u>2</u>	+	<u>4</u>	=	<u>8</u>
Failure Potential		Size of part		Target Rating	=	Hazard Rating
<input checked="" type="checkbox"/> Immediate action needed						
<input type="checkbox"/> Needs further inspection						
<input type="checkbox"/> Dead tree						

**TREE CHARACTERISTICS**

Tree #: 1-5 Species: Pinus contorta Area Lodgepole Pines  
 DBH: 8-14 # of trunks: 1 Height: 30 Spread: 20 Shore Pine  
 Form:  generally symmetric  minor asymmetry  major asymmetry  stump sprout  stag-headed  
 Crown Class:  dominant  co-dominant  intermediate  suppressed  
 Live crown ratio: 30% Age Class:  young  semi-mature  mature  over-mature/senescent  
 Pruning History:  crown cleaned  excessively thinned  topped  crown raised  pollarded  crown reduced  flush cuts  cabled/braced  
 none  multiple pruning events Approx. dates: \_\_\_\_\_  
 Special Value:  specimen  heritage/historic  wildlife  unusual  street tree  screen  shade  indigenous  protected by gov. agency

**TREE HEALTH**

Foliage Cover:  normal  chronic  necrotic Epicormics? Y N  
 Foliage Density:  normal  sparse Leaf size:  normal  small  
 Annual shoot growth:  excellent  average  poor Twig Dieback? Y N  
 Woundwood development:  excellent  average  poor  none  
 Vigor class:  excellent  average  fair  poor  
 Major pests/diseases: NONE OBSERVED

Growth obstructions:  
 stakes  wire/ties  signs  cables  
 curb/pavement  guards  
 other \_\_\_\_\_

**SITE CONDITIONS**

Site Character:  residence  commercial  industrial  park  open space  natural  woodland/forest  
 Landscape type:  parkway  raised bed  container  mound  lawn  shrub border  wind break  
 Irrigation:  none  adequate  inadequate  excessive  trunk wetted  
 Recent site disturbance? Y N  construction  soil disturbance  grade change  line clearing  site clearing  
 % dripline paved: 0% 10-25% 25-50% 50-75% 75-100% Pavement lifted? Y N  
 % dripline w/fill soil: 0% 10-25% 25-50% 50-75% 75-100%  
 % dripline grade lowered: 0% 10-25% 25-50% 50-75% 75-100%  
 Soil problems:  drainage  shallow  compacted  droughty  saline  alkaline  acidic  small volume  disease center  history of fall  
 clay  expansive  slope \_\_\_\_\_? aspect: \_\_\_\_\_  
 Obstructions:  lights  signage  line-of-site  view  overhead lines  underground utilities  traffic  adjacent veg.  \_\_\_\_\_  
 Exposure to wind:  single tree  below canopy  above canopy  recently exposed  windward, canopy edge  area prone to windthrow  
 Prevailing wind direction: S-SW Occurrence of snow/ice storms  never  seldom  regularly

**TARGET**

Use Under Tree:  building  parking  traffic  pedestrian  recreation  landscape  hardscape  small features  utility lines  
 Can target be moved? Y N  Can use be restricted? Y N   
 Occupancy:  occasional use  intermittent use  frequent use  constant use

**TREE DEFECTS**

**ROOT DEFECTS:**  
 Suspect root rot:  Y  N Mushroom/conk/bracket present:  Y  N ID: \_\_\_\_\_  
 Exposed roots:  severe  moderate  low Undermined:  severe  moderate  low  
 Root pruned: \_\_\_\_\_ Root area affected: \_\_\_\_\_% Buttress wounded:  Y  N When: \_\_\_\_\_  
 Restricted root area:  severe  moderate  low Potential for root failure:  severe  moderate  low  
 LEAN: \_\_\_\_\_ deg. From vertical  natural  unnatural  self-corrected Soil heaving:  Y  N  
 Decay in plane of lean:  Y  N Roots broken:  Y  N Soil cracking:  Y  N  
 Compounding factors: \_\_\_\_\_ Lean severity:  severe  moderate  low  
**CROWN DEFECTS:** Indicate presence of individual defects and rate their severity (s=severe, m=moderate, l=low)

DEFECT	ROOT CROWN	TRUNK	SCAFFOLDS	BRANCHES
Poor taper		✓ M		
Bow, sweep				
Codominants/forks				
Multiple attachments		✓ M	✓ M	
Included bark		✓		
Excessive end weight			✓ S	
Cracks/splits			✓	
Hangers				
Girdling				
Wounds/seam				
Decay				
Cavity				
Conks/mushrooms/bracket				
Bleeding/sap flow				
Loose/cracked bark				
Nesting hold/bee hive			✓ M	
Deadwood/stubs			✓ M	
Borers/termites/ants				
Cankers/galls/burrs			✓ M	
Previous failure				

**HAZARD RATING**

Tree part most likely to fall: MAJOR STRUCTURE  
 Inspection period: \_\_\_\_\_ annual \_\_\_\_\_ biannual \_\_\_\_\_ other \_\_\_\_\_  
 Failure Potential + Size of Part + Target Rating = Hazard Rating  
2 + 2 + 4 = 8

Failure potential: 1-low; 2-medium; 3-high; 4-severe  
 Size of part: 1 - <6" (15 cm); 2 - 6-18" (15-45 cm);  
 3 - 18-30" (45-75 cm); 4 - > 30" (75 cm)  
 Target rating: 1 - occasional use; 2 - intermittent use;  
 3 - frequent use; 4 - constant use

**HAZARD ABATEMENT**

Prune:  remove defective part  reduce end weight  crown clean  thin  raise canopy  crown reduce  restructure  shape  
 Cable/Brace: \_\_\_\_\_ Inspect further:  root crown  decay  aerial  monitor  
 Remove tree:  Y  N Replace?  Y  N Move Target:  Y  N Other: \_\_\_\_\_  
 Effect on adjacent trees:  none  evaluate  
 Notification:  owner  manager  governing agency Date: 10-2-2023

**COMMENTS**

There are multiple structural defects in 5 trees that are not correctable by pruning, therefore removal is recommended. The other five trees should be evaluated in 12-18 months.

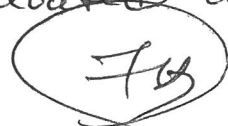

# Balden & Associates Arboriculture Services

**Joe Balden**  
Consulting Arborist PN0736

41500 Anderson Road  
Nehalem, OR 97131  
503.368.7807 office  
503.801.3762 cell  
joebalden70@gmail.com

October 2, 2023

Don Frank  
988 Summit Ave.  
PO Box 2641  
Gearhart, OR 97138  
[don@donfrankphotography.com](mailto:don@donfrankphotography.com)

Dear Don,  
Per your request I have evaluated the pine trees located on the east side of your property identified as 988 Summit Ave. on September 25, 2023.

**Observed:**

Line of coast pine consisting of 9 trees, age approximately 20-25 years. Size range from 8-18" DBH. Height 30'.

Concern is for tree health, structure, and potential failure in storm conditions.

Evaluation. The trees have healthy crowns with normal foliage. Pruning history has been minimal involvement to lower branch removals.

Structural problems identified; Narrow crotch angle of scaffold branch attachment to the main stem and each other that leads to failure as tree builds additional layers of tissue which is more obvious on some trees than others. It is the narrow angle of wood tissue layering in annual growth that gradually forces branches to separate from each other or from the main trunk of the tree.

The potential for failure varies depending on growth angles. I have identified 5 trees that have the highest potential for failure in the near future.

These 5 trees are marked with orange paint that have the highest level of potential failure and are recommended for removal. (refer to site diagram).

Sincerely,

  
Joe Balden

**Attachments:**

Tree Hazard Evaluation Form  
Tree Location Site Diagram  
Site Location Diagram

Balden Arboriculture Services  
41500 Anderson Road  
Nehalem, OR 97131  
503-801-3762

TREE LOCATION SITE DIAGRAM

Client: DON FRANK  
988 SUMMIT AVE.  
GEARHART, OR

Date: 10-2-2023

Project: TREE EVALUATIONS

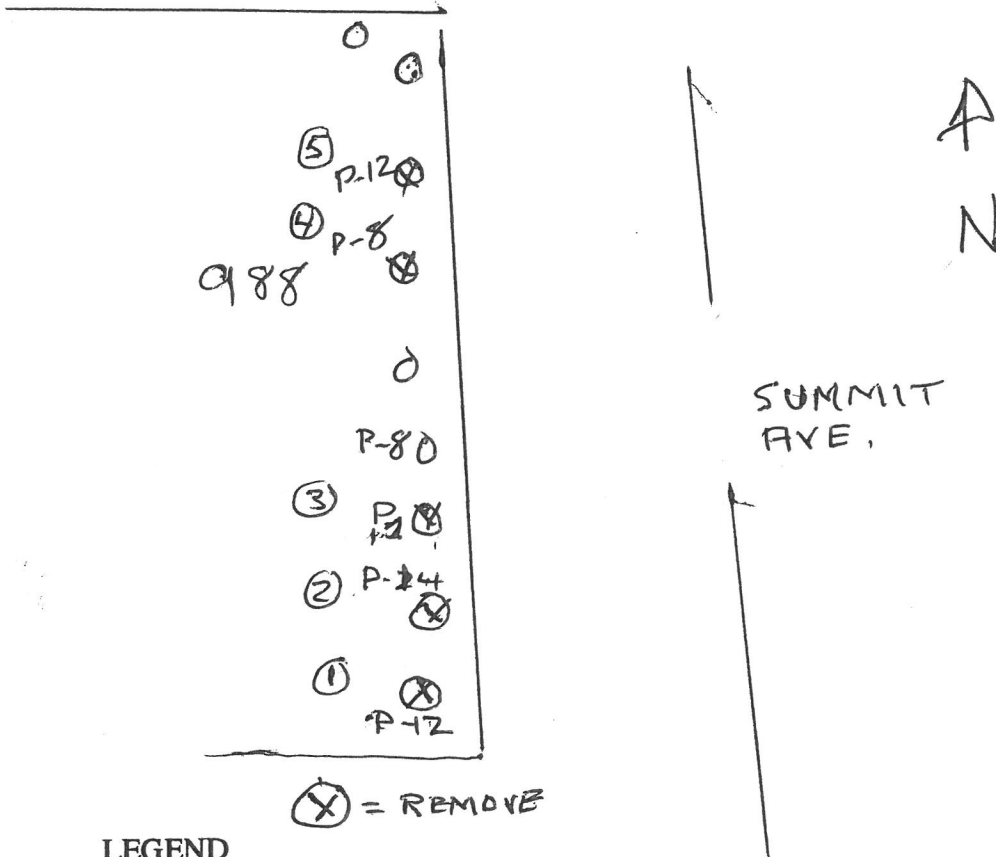

(X) = REMOVE

LEGEND

Tree # 1-5 (X)

Species PINE

Size (DBH)

Recommendations REMOVE PER EVALUATOR

Sketch not to scale